

2
BED

Stunning Two Bedroom Family House With Views

38, St. Leonards Close, Newhaven, BN9 0RW



Price £265,000

Freehold

phillipmann
we do more

www.phillipmann.com

38 St Leonards Close, BN9 0RW

Approximate Gross Internal Floor Area = 72.76 sq m / 783 sq ft

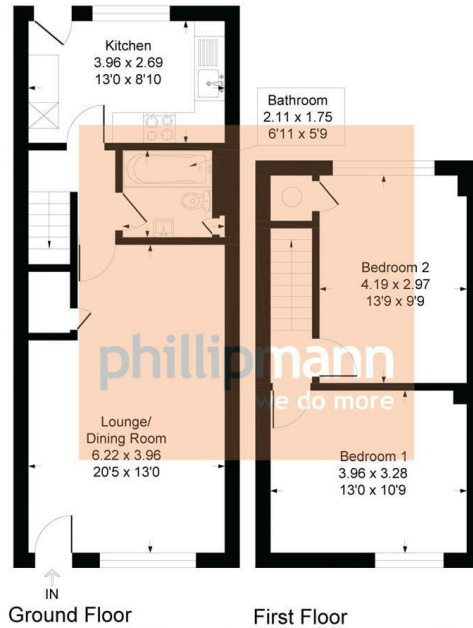

inbrief...

Phillip Mann estate agents are delighted to offer this stunning two bedroom house located in Denton Village. The property is in superb condition throughout and backs directly onto woodland. An internal viewing is highly recommended.

A part glazed door gives access directly into the bright lounge/diner which is a wonderful room. There is ample space for a dining table and a window overlooks the front of the property. To the rear, there is a refitted kitchen which has a range of wall and base units which incorporates a selection of cupboards and drawers. There is a built in sink unit along with a cooker and hob. There is further appliance space which includes a washing machine, dishwasher and tumble drier. A large window overlooks the rear garden. Completing the downstairs is a refitted bathroom which has a paneled bath with shower over, WC and wash hand basin.

The first floor has two large bedrooms. Bedroom one is a generous size with space for wardrobes and a window overlooks the front enjoying lovely views of the South Downs. Bedroom two overlooks the rear along with storage and is a further double.

Outside there is a low maintenance rear garden which is laid to patio.

There is communal parking to the front.

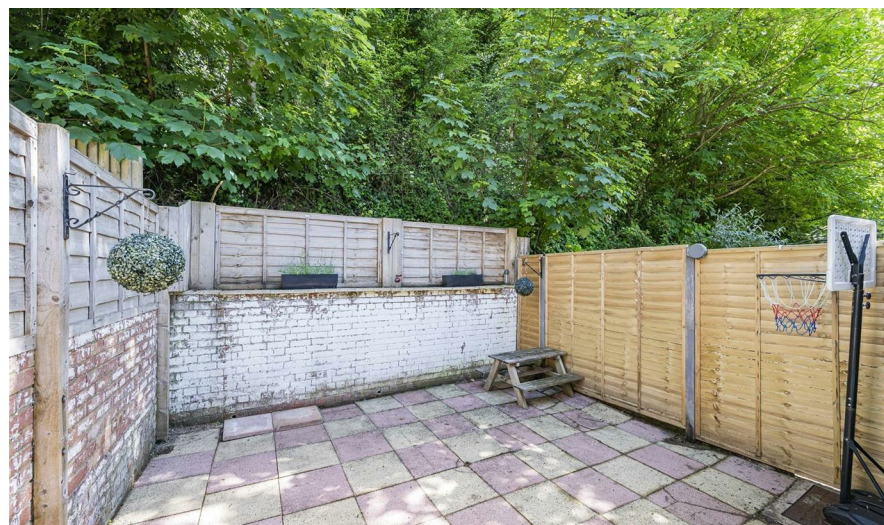

Energy Rating C

Council Tax B

moreinfo...



Phillip Mann Newhaven Office
16 Bridge Street, Newhaven, BN9 9PJ
01273 517517

To see more details on this & all our homes go to www.phillipmann.com